



PROPERTY TAX  
Marshall County, Alabama

Current Date: 11/17/2023 Tax Year: 2024

**!** You are viewing a future tax year. Any values and taxes shown are estimates and are subject to change. [Click here](#) for the current amount due.

Parcel Info

PIN 3767  
 PARCEL 06-04-18-0-000-047.000  
 ACCOUNT NUMBER 520982

OWNER NEW LIFE METHODIST CHURCH  
 MAILING ADDRESS 5256 MAIN ST, GRANT, AL 357478317  
 PROPERTY ADDRESS 5152 2ND AVENUE

LEGAL DESCRIPTION COM INT ELY R/W CO RD 63 & NLY  
 R/W 2ND ST SEC 18 T6S R4E 699/284  
 101781

EXEMPT CODE S  
 TAX DISTRICT Grant



Tax Information

TAXES ARE DUE ON 10/1/2024

PPIN	YEAR	TAX TYPE	TAX DUE	PAID	BALANCE
3767	2024	REAL	\$ 0.00	\$ 0.00	\$ 0.00

**Total Due: \$ 0.00**

LAST PAYMENT DATE \*\*N/A\*\*  
PAID BY

## Property Values

<b>Total Acres</b>	
<b>Use Value</b>	\$0
<b>Land Value</b>	\$8,500
<b>Improvement Value</b>	\$163,600
<b>Total Appraised Value</b>	\$172,100
<b>Total Taxable Value</b>	\$172,100
<b>Assessment Value</b>	\$34,420

## Subdivision Information

<b>Code</b>	
<b>Name</b>	
<b>Lot</b>	
<b>Block</b>	
<b>Type / Book / Page</b>	9 / 6945 / 306
<b>S/T/R</b>	18-6S-4E

## Detail Information

TYPE	REF	DESCRIPTION	LAND USE	TC	HS	PN	APPRAISED VALUE
LAND	1	0.000 Acres	691-RELIGIOUS ACTIVITIES	2	N	N	\$8,500
RES/COM	1	111 - SINGLE FAMILY	-	2	N	N	\$163,600

## Building Components

### Improvement

<b>Year Built</b>	1978
<b>Structure</b>	SINGLE FAMILY
<b>Structure Code</b>	111
<b>Total Living Area</b>	2842
<b>Building Value</b>	\$163,600

### Materials and Features

<b>Foundation</b>	CONTINUOUS WALL - 100
<b>Exterior Walls</b>	STONE ON MASONRY - 25
<b>Exterior Walls</b>	VINYL SIDING - 75
<b>Roof Type</b>	HIP-GABLE - 100
<b>Roof Material</b>	METAL, CORRUGATE - 100
<b>Floors</b>	CARPET & UNDERLA - 100
<b>Interior Finish</b>	DRYWALL(SHEETROC - 50
<b>Interior Finish</b>	PLYWOOD - 50
<b>Plumbing</b>	AVERAGE - 100
<b>Plumbing</b>	BATH 3FIX - 1
<b>Plumbing</b>	BATH 2FIX - 1
<b>Heat/AC</b>	HT06 FHA/AC - 2842

### Computations

<b>Stories</b>	2.0
<b>1st Level Sq. Ft.</b>	1421
<b>Add'l Level Sq. Ft.</b>	1421
<b>Total Living Area</b>	2842
<b>Total Adjusted Area</b>	3111

## Photos



## Sketches

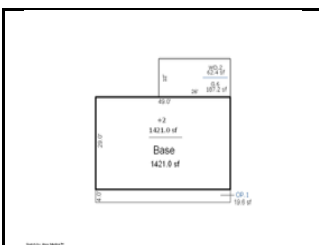

## Tax Sales

**\*\*NO TAX SALES FOUND\*\***